

# Competicon – Principales

Fabricante	DANPAL	Kalwall	Rodeca	Dott.Gallina
Velocidad de Instalación	200m <sup>2</sup> /shift	N/A	50m <sup>2</sup> /shift	25m <sup>2</sup> /shift for double skin 16m <sup>2</sup> /shift for triple skin
Valor U	Down to 0.5W/m <sup>2</sup> .K	Down to 0.28W/m <sup>2</sup> .K (but no more light...)	Down to 0.9W/m <sup>2</sup> .K	Down to 0.62W/m <sup>2</sup> .K (triple skin)
Distancia entre los 2 soportes	<b>K7: 3m</b> <b>K12: 4m</b>	N/A	1.80m	2.50m
Certificaciones	CSTB Technical Approval		CSTB Technical Approval	CSTB Technical Approval
Tiempo de entrega [semanas]	5 – 9	18	4	4
Precio [\$/m <sup>2</sup> ]	130 - 180	250- 400	50 - 90	100 - 130

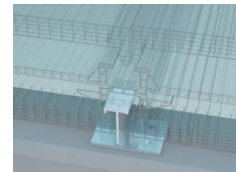

# Competicon – Principales Empresas

Fabricante	<b>DANPAL</b>	<b>Kalwall</b>	<b>Rodeca</b>	<b>Dott.Gallina</b>
Hecho en	Israel, France	USA	Germany	Italy, USA
Nombre del Sistema	<b>DANPATHERM K7, K12</b>	<b>Kalwall</b>	<b>PC 2550</b>	<b>Arcotherm</b>
Descripcion	<b>Unitized</b>	<b>Unitized</b>	<b>Site assembled</b>	<b>Site assembled</b>
	Factory assembled units, including corners and angles cuts	Factory assembled pieces of façade, made of 2 skins of composite material embedding glass fiber insulation. The structure is made of aluminum	Male female panels to be inserted on site  Basically it is not a real system...	Triple skin cut and installed skin by skin on site  Basically it is not a real system
Disponibile desde	Product since 2009 Company since 1981	Company since 1955	Company since 1971	Product since 2015 Company since 1960
Espesor [mm]	<b>70 or 120</b>	<b>70 or 100</b>	<b>40 or 50 or 60</b>	<b>90</b>
Anchura [mm]	<b>K7: 624, 924, K12: 600, 900</b>	<b>1200 or 1500</b>	<b>600 or 500</b>	<b>600</b>
Longitud [m]	Up to 12	0.9 to 6.1	Up to 7	Up to 16

